

JC180041

ToughLED™ Pro

ToughLED™ Pro 1500mm 5ft Single 29W IP65 4000K WOP

Features & Benefits

- High efficiency up to 145 lpcW
- 90° Lock-in-place side clip design, keeps clips clear during installation
- Detachable 4 pin terminal block with multiple positions adjacent to all cable entry points
- Inbuilt loop-in/loop-out cable restraints to ensure that cables do not clash when closing the fixture
- Plug & play emergency & microwave sensor modules with optional remote control
- Ultra-wide surface mount bracket rail to enable flexibility to locate joists
- Wide body for retrofitting BESA conduit box mounting, with rear, side and end conduit entry points
- Unique rear IP65 gasket, sealing cable entry from within the fixture for surface mounting applications
- 4ft, 5ft, 6ft single and twin light outputs in both opal and prismatic diffuser options
- Microwave step dimmable, DALI and 1-10V dimmable options available
- 5-year extended warranty on fixture and batteries, which uses LifePO4 batteries for improved performance and life



BEAM



CLASS I



CRI:RA



RATING



RATING



WARRANTY

General Information

Mounting

Surface or Suspended

Environment

Suitable for exterior and interior applications

Suitable For Zones

Zone 1

Product Group

LED - Surface

Product Range

ToughLED™ Pro

IK Rating

IK08

Trade Name

ToughLED™ Pro

Color Finish

Grey

Product Shape

Rectangular

Product Weight(kg)

1.70

Overall Dimensions

1570 x 96 x 81.3

Light Source

LED

Recommended Product Location

Wall or Ceiling Mount or suspended, suitable for a wide variety of applications. Including Warehouses/storage

Method Of Fix	facilities. Car parks and manufacturing.
Distance From Lighted Object	Mounting Brackets, Suspension chains or conduit mounting
IP Rating	0.3m
Origin of manufacturer	IP65
Warranty	Made in China
Driver Manufacturer	2 years standard warranty extends to 5 years when registered within the first year of purchase (See Website for terms and conditions)
LED Manufacturer/Type	JCC
	BMTC/2835

Electrical

Voltage Rating	220-240
Primary Running Current(Amp)	0.25
Inrush current(Amps)	8
Operating Frequency Hz	50/60Hz
Secondary running current(mA)	500
Constant Current or Constant Voltage	CC
Luminaire Circuit Wattage	29
Class	I
Output Voltage Max/Range (VDC)	66VDC max
Total Harmonic Distortion (THD)%	<20
EMC Compliant (EN55015)	Yes
Power Factor Correction	0.9
Input Electrical Connections	Live, Earth, Neutral
Dimmable	No

Thermals

Thermal Cut Out	Yes
Operating Temperature Range °C	-20 to +50

Performance Data

LED Life (Hours)	54000
------------------	-------

Hours life stated is an indication of expected L70 chip and light output calculations when operating in optimum conditions. Product warranty period supports the full product during the term given. The L70 hours expectancy is not correlated with the full product warranty term, nor is it a representation of lumen depreciation during the warranty period.

Energy Rating	This product contains a light source of energy efficiency class D
Actual Lumen Output	3900
Lumens Per Circuit Watt	134
Standard Deviation Colour Matching - SDCM	<5
Color Rendering Index	80-89
CRI: Ra	80
Correlated Color Temperature	4000K
Beam Angle °	120

LOR (Light Output Ratio) %

100

Photometry Available

Yes: available on request.

Construction

Primary Material

Polycarbonate

Outer Diffuser

Polycarbonate

Driver Housing

Polycarbonate

Packaging

Product carton overall dimensions(cm)

157.5 x 10 x 8.5

Product Packaged Weight(kg)

1.91

Quantity Per Outer Carton

9

Outer carton(L)- cm

159

Outer carton(W)- cm

31.5

Outer carton(H)- cm

27

Outer carton Net weight- kg

17.16

Outer carton Gross weight- kg

18.06

Product Bar Code EAN-13 Number

5052544110276

Outer carton Bar Code ITF-14 Number

15052544110273

Standards & Approvals

Manufactured In Accordance To

BS EN 60598:2015, 2-1

CE Marked

Yes

UKCA Marked

Yes

Date code/Purchase order No.

Yes

WEEE Symbol

Yes

Certificate Of Conformity

Available on request

Accredited Members

LIA, ISO9001-2015, ISO14001-2065

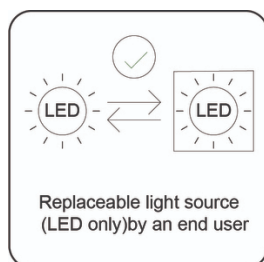

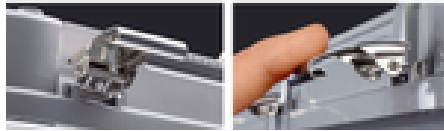
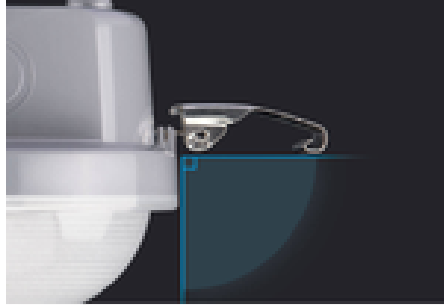



JCC Lighting LTD, Lux Park, Chichester Business Park, City Fields Way, Tangmere, Chichester, West Sussex, PO20 2FT.
Sales: 01243 838999 (8am to 5pm Monday to Friday) Fax: 01243 838998 | sales@jcc.co.uk | www.jcc.co.uk
Company Registration Number: 03044848 | VAT Number: 918544112

This document is uncontrolled if printed, all information is subject to change

Version 197 [30/09/2022]